



SCAN ME



For more information

01489 570019

www.sbk4homes.com

25 Knotgrass Road, Locks Heath, Southampton,
Hampshire, SO31 6XH.

2 Bedrooms, 1 Bathrooms

- Available Immediately
- End Of Terrace House
- Modern Presentation
- Two Double Bedrooms
- Kitchen/Breakfast Room
- Good Sized Lounge
- Refitted Bathroom Suite
- Enclosed Rear Gardens
- Two Allocated Parking Spaces
- Tucked Away Position



£1,200 PCM



For more information

01489 570019

www.sbk4homes.com

2 Bedrooms, 1 Bathrooms

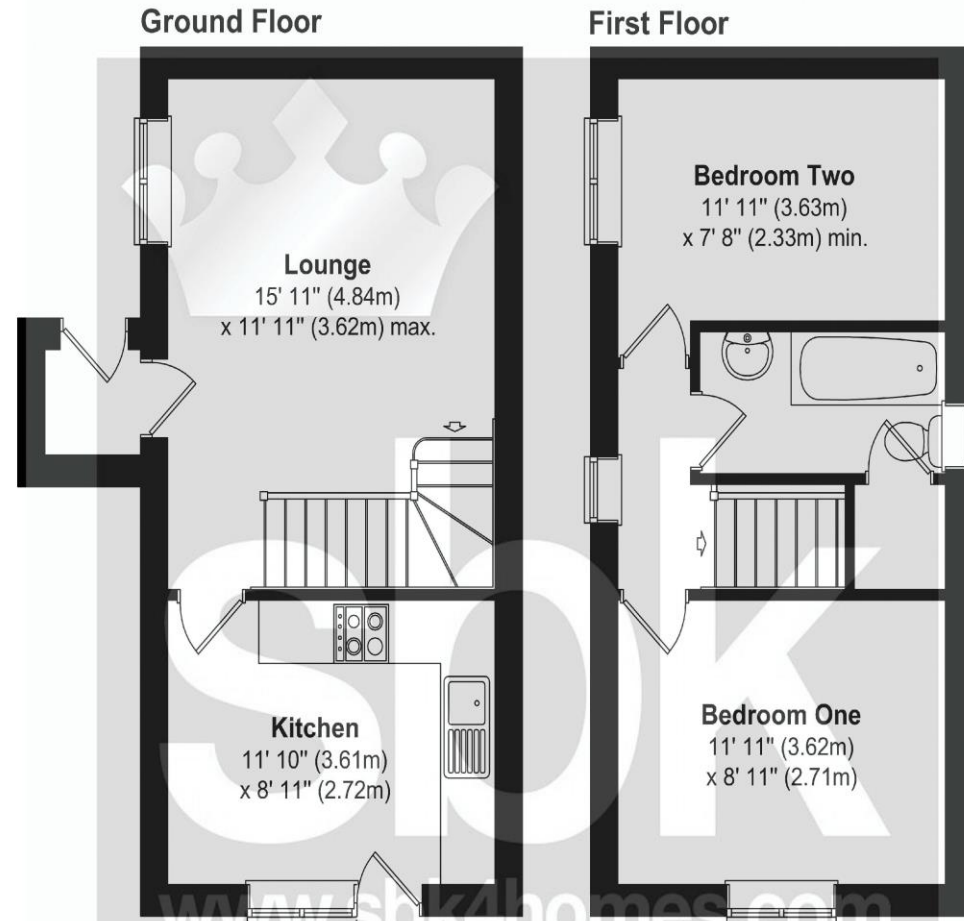

Approx. Gross Internal Floor Area 593 SQ FT 55 SQ Metres

Whilst every attempt has been made to ensure the accuracy of the floor plans, measurements of doors, windows and rooms are approximate and no responsibility is taken for any error, omission or mis-statement. These plans are for representation purposes only and should be used as such. The services, systems and appliances listed in this specification have not been tested by SBK Property Consultants and no guarantee as to their operating efficiency can be given.

Council Tax: Band - C
Payable £1,834.14
April 2024 - March 2025
Fareham Borough Council.

EPC: Band - B

Availability Date:
The property is available
immediately.

Pets:
No

Parking:
Yes - two allocated
parking spaces

For more information

01489 570019
www.sbk4homes.com



Available to rent immediately is this modern, two bedroom end of terrace house. The property has previously seen a number of improvements which includes the replacing of the kitchen and bathroom. The well proportioned accommodation comprises of an entrance porch, good size living room, a modern kitchen/breakfast room with space for a table and chairs and to the first floor are two double bedrooms and a beautifully appointed bathroom suite. The property is tucked away in a pleasant spot at the end of the cul de sac with two allocated parking spaces located adjacent to the property. To avoid missing out on this property, please contact our lettings team.



For more information



01489 570019
www.sbk4homes.com